

Stainless Steel, Welded Seal S-Beam Load Cell

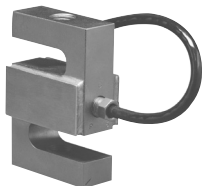

60001/60050 S-Beam

FEATURES

- Rated capacities of 500 to 20,000 pounds
- Stainless steel, welded seal construction
- Integral loading brackets
- Compatible with TCM tension mounting hardware
- Mounting and loading accessory hardware available
- Designed for single or multiple load cell applications
- Trade certified for NTEP Class III:10,000 divisions and III:5,000 divisions
- *Sensorgage*™ sealed to IP67 standards
- *Cell Guard*™ Two Year Warranty
- Factory Mutual System Approved for Classes I, II, III; Divisions 1 and 2; Groups A through G. Also, Non-incendive ratings (No Barriers!).
- ISO 9001:2000 Certified manufacturing facilities

APPLICATIONS

- Hostile environments:
Food and beverage processing
Chemical and plastics processing
Pharmaceutical and biomedical
- Bin, hopper and belt conveyor scales
- Level and inventory monitoring
- Tension and compression measurements

RATED CAPACITIES
lbs
500, 750, 1K, 1.5K, 2K, 2.5K, 3K, 5K, 10K, 15K, 20K

FULL SCALE OUTPUT (FSO)
lbs
2.0 mV/V +25% / -10%

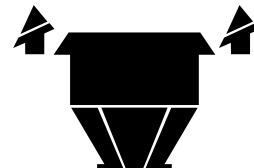

ACCURACY CLASS			
	STANDARD	NTEP III⁽¹⁾	NTEP IIIIL⁽¹⁾
Max. No. Verification Intervals	-- Multiple	5,000 Multiple	10,000
Combined Error % FSO	≤ 0.03	--	--
Nonlinearity % FSO	≤ 0.03	--	--
Hysteresis % FSO	≤ 0.02	--	--
Creep Error % FSO	≤ 0.03 in 20 minutes	--	--
Temperature Effect on:			
• Zero % FSO/°F	≤ 0.0015	--	--
• Output % of Load/°F	≤ 0.0008	--	--

Note: (1) 500 - 5K capacities only.

PERFORMANCE SPECIFICATIONS

Non-Repeatability % FSO: ≤ 0.1

Zero Balance % FSO: ≤ 1.0

Insulation Resistance: >1000 Mohms at 50 VDC

Compensated Temperature Range: 14° to 104°F [-10° to 40°C]

Operating Temperature Range: 0° to 150°F [-18° to 65°C]

Storage Temperature Range: -60° to 185°F [-50° to 85°C]

Input Resistance: 349-450 Ohms

Output Resistance: 349-355 Ohms

Recommended Excitation Voltage: 10 Volts DC

Maximum Excitation Voltage: 15 Volts DC

Safe Overload: 150% of Rated Capacity

Ultimate Overload: 300% of Rate Capacity

Sealing: Meets IP67 Standards

Material: Alloy Tool Steel

CAPACITY						
	A	B	C	D	DEFLECTION	WEIGHT
500 - 3K	1/2-20	1.00	2.00	3.00	0.010	3.00
5K - 10K	3/4-16	1.00	3.50	4.75	0.010	5.00
15K	1-14	1.25	4.00	5.50	0.010	8.00
20K	1 1/4-12	2.00	5.00	7.00	0.010	19.00

Dimensions are in inches. Capacities are in pounds. Deflection is ±10%. Specifications are subject to change. Certified drawings are available.